

A

B

C

D

E

PHASING LEGEND

- EXISTING CONDITIONS - STILL IN USE
- TEMPORARY PHASE
- UNDER CONSTRUCTION
- COMPLETED AND IN USE
- STAGING AREA FOR CONSTRUCTION

- KEY**
- PHASE ONE (1): SUMMER 2025
 - PHASE TWO (2): SCHOOL YEAR 2025-2026
 - PHASE THREE (3): SUMMER 2026
 - PHASE FOUR (4): SCHOOL YEAR 2026-2027
 - PHASE FIVE (5): SUMMER 2027

TEMPORARY PARTITIONS

NOTES: SEE RELATED PHASING INFO. UNDER OTHER DISCIPLINES - SITE, MEP, COMMUNICATIONS, FIRE PROTECTION.

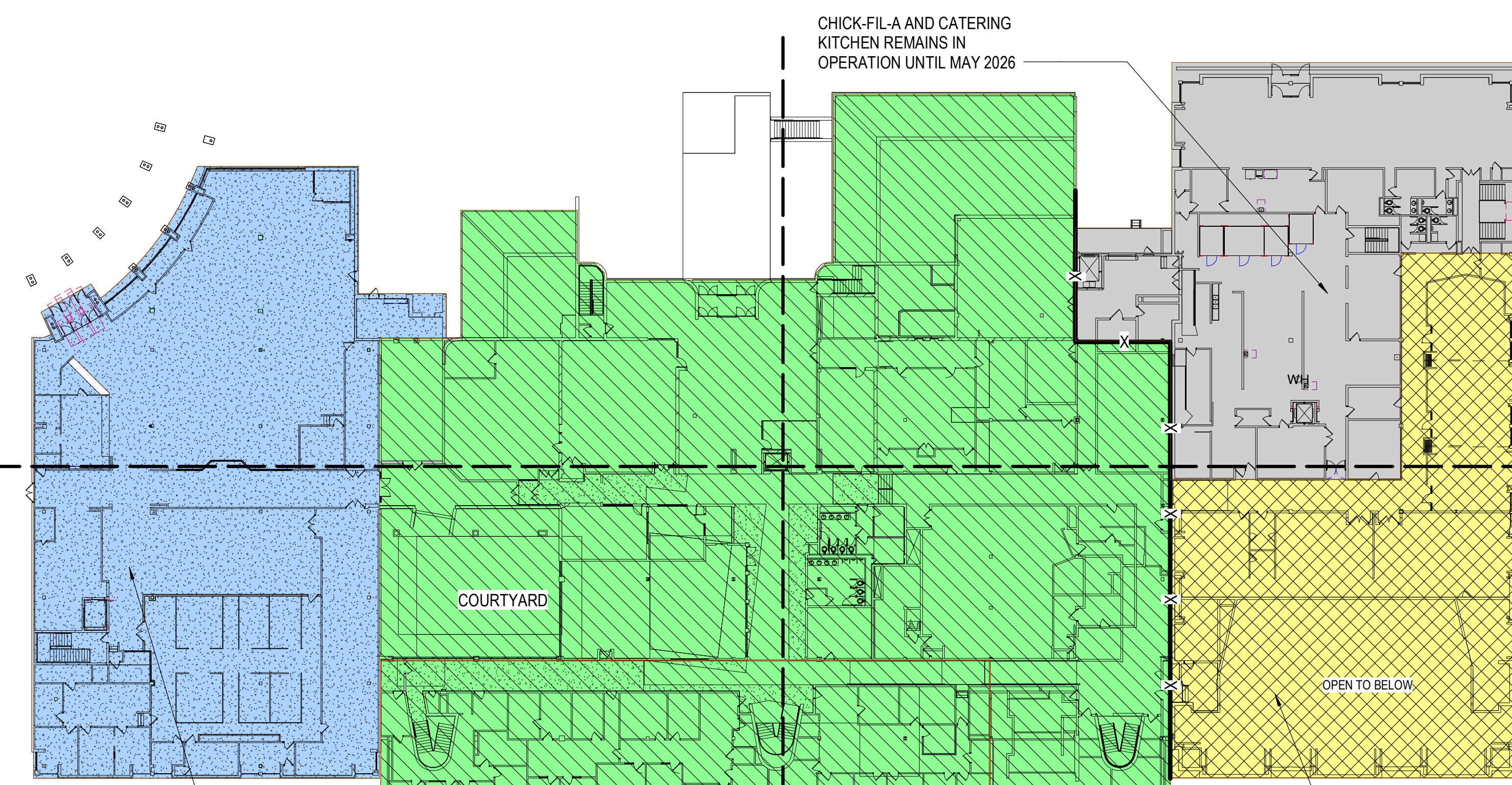

PHASE ONE - SECOND FLOOR

CLEAR OUT AREA FOR CONTRACTOR USE AND/OR SECONDARY OPTION FOR DINING SPACE AND/OR TEMPORARY STAFF OFFICE SPACE

CHICK-FIL-A AND CATERING KITCHEN REMAINS IN OPERATION UNTIL MAY 2026

OPEN TO BELOW

PREPARE AREA FOR TEMPORARY DINING DURING SUMMER 2025. REMOTE OPERATIONS HANDLES SUMMER TRAFFIC

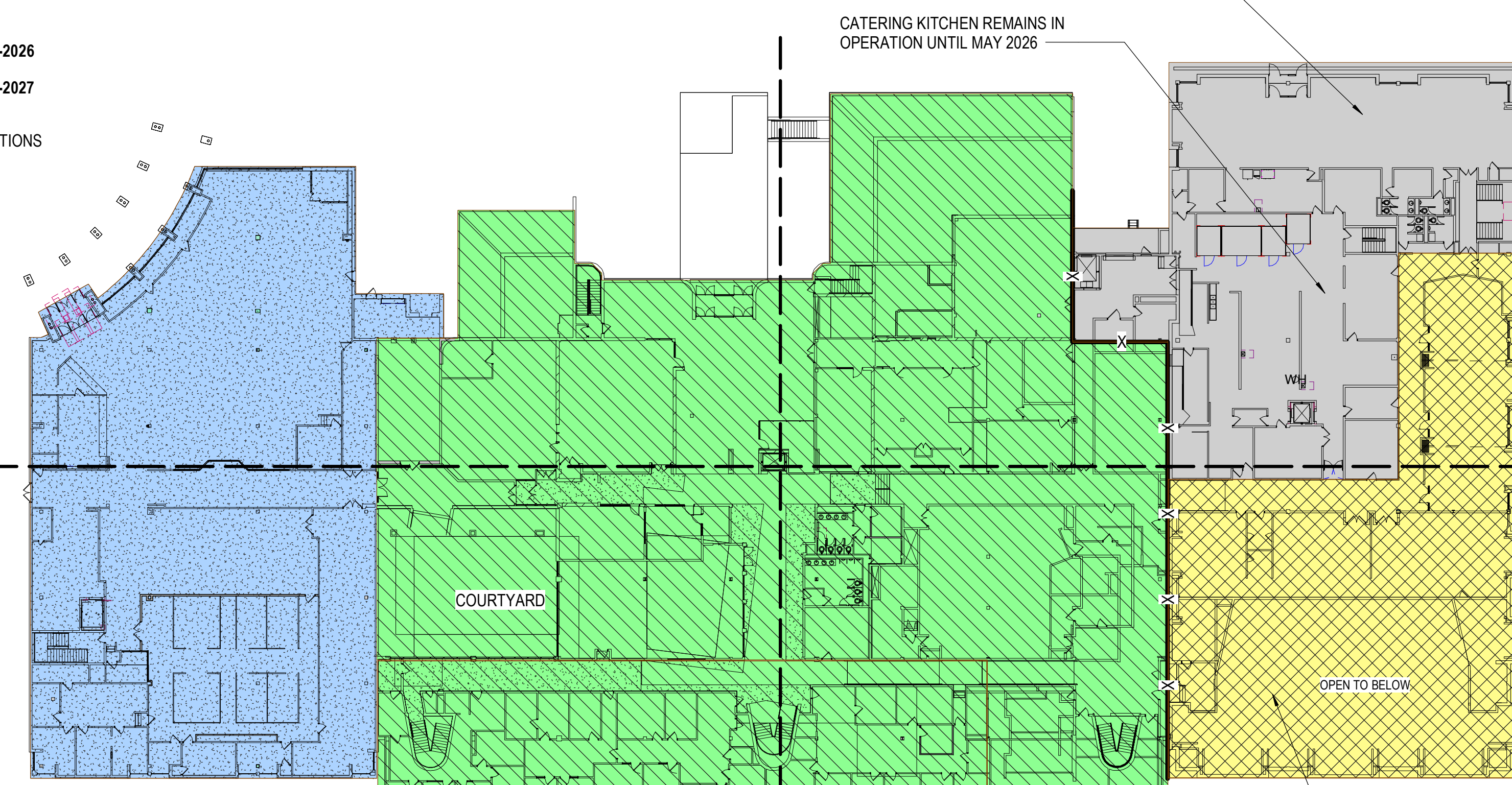

PHASE TWO - SECOND FLOOR

CHICK-FIL-A REMAINS IN OPERATION UNTIL MAY 2026

CATERING KITCHEN REMAINS IN OPERATION UNTIL MAY 2026

OPEN TO BELOW

TEMPORARY DINING DURING SCHOOL YEAR 2025-2026

PHASING LEGEND

- EXISTING CONDITIONS - STILL IN USE
- TEMPORARY PHASE
- UNDER CONSTRUCTION
- COMPLETED AND IN USE
- STAGING AREA FOR CONSTRUCTION

- KEY**
- PHASE ONE (1): SUMMER 2025
 - PHASE TWO (2): SCHOOL YEAR 2025-2026
 - PHASE THREE (3): SUMMER 2026
 - PHASE FOUR (4): SCHOOL YEAR 2026-2027
 - PHASE FIVE (5): SUMMER 2027

TEMPORARY PARTITIONS

NOTES: SEE RELATED PHASING INFO. UNDER OTHER DISCIPLINES - SITE, MEP, COMMUNICATIONS, FIRE PROTECTION.

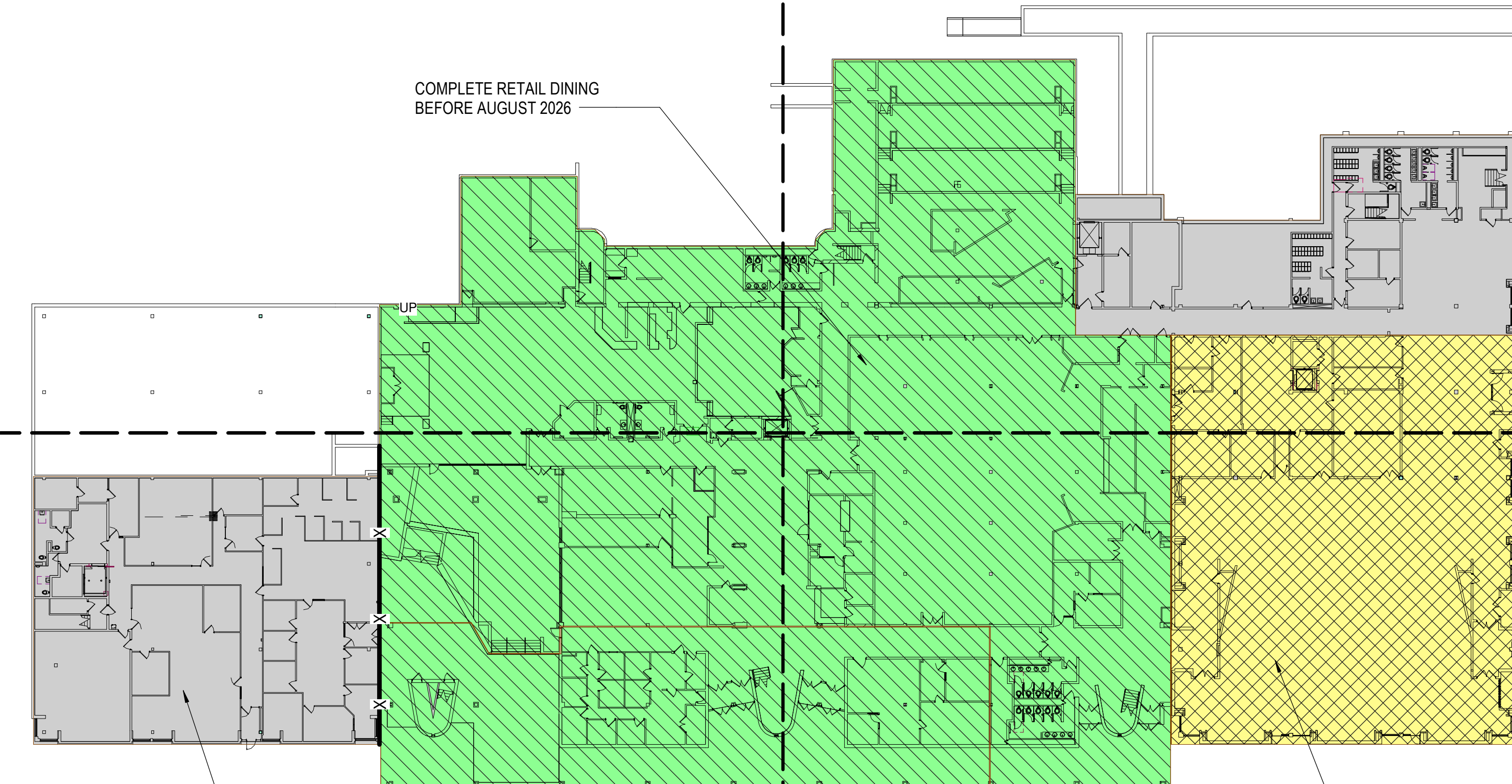

PHASE ONE - FIRST FLOOR

COMPLETE RETAIL DINING BEFORE AUGUST 2026

EXISTING OFFICES TO REMAIN IN USE UNTIL MAY 2026

PREPARE AREA FOR TEMPORARY DINING DURING SUMMER 2025. REMOTE OPERATIONS HANDLES SUMMER TRAFFIC

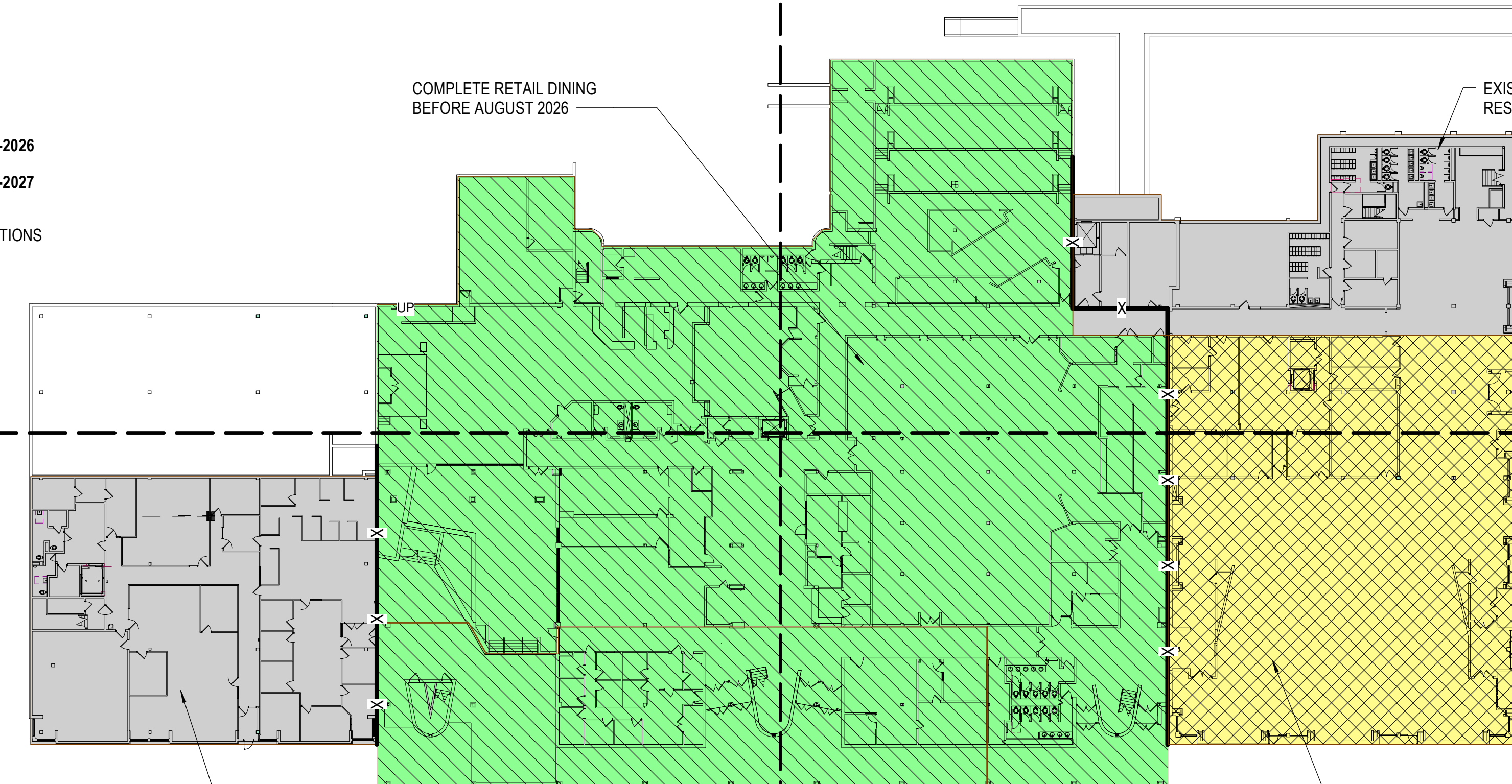

PHASE TWO - FIRST FLOOR

COMPLETE RETAIL DINING BEFORE AUGUST 2026

EXISTING FIRST FLOOR RESTROOMS TO REMAIN

EXISTING FIRST FLOOR EXITING TO REMAIN

TEMPORARY DINING DURING SCHOOL YEAR 2025-2026

Rev	Date	Comment

NOT FOR CONSTRUCTION

ISSUED: 06/12/2024

STUDENT CENTER RENOVATION

YOUNGSTOWN STATE UNIVERSITY

Phasing Plans

DESIGN DEVELOPMENT

WTW PROJECT NO. 72-3046
© WTW ARCHITECTS 2024

AP2.1

6/11/2024 1:55:40 PM

Rev	Date	Comment

**NOT FOR
CONSTRUCTION**

ISSUED: 02/05/2024

**STUDENT
CENTER
RENOVATION**

YOUNGSTOWN
STATE
UNIVERSITY

**1st Floor
Existing
Program
Plan**

DESIGN
DEVELOPMENT

WTW PROJECT NO. 72-3046
© WTW ARCHITECTS 2024

EXP1.1

6/11/2024 1:55:42 PM

A
B
C
D
E

1

2

3

4

5

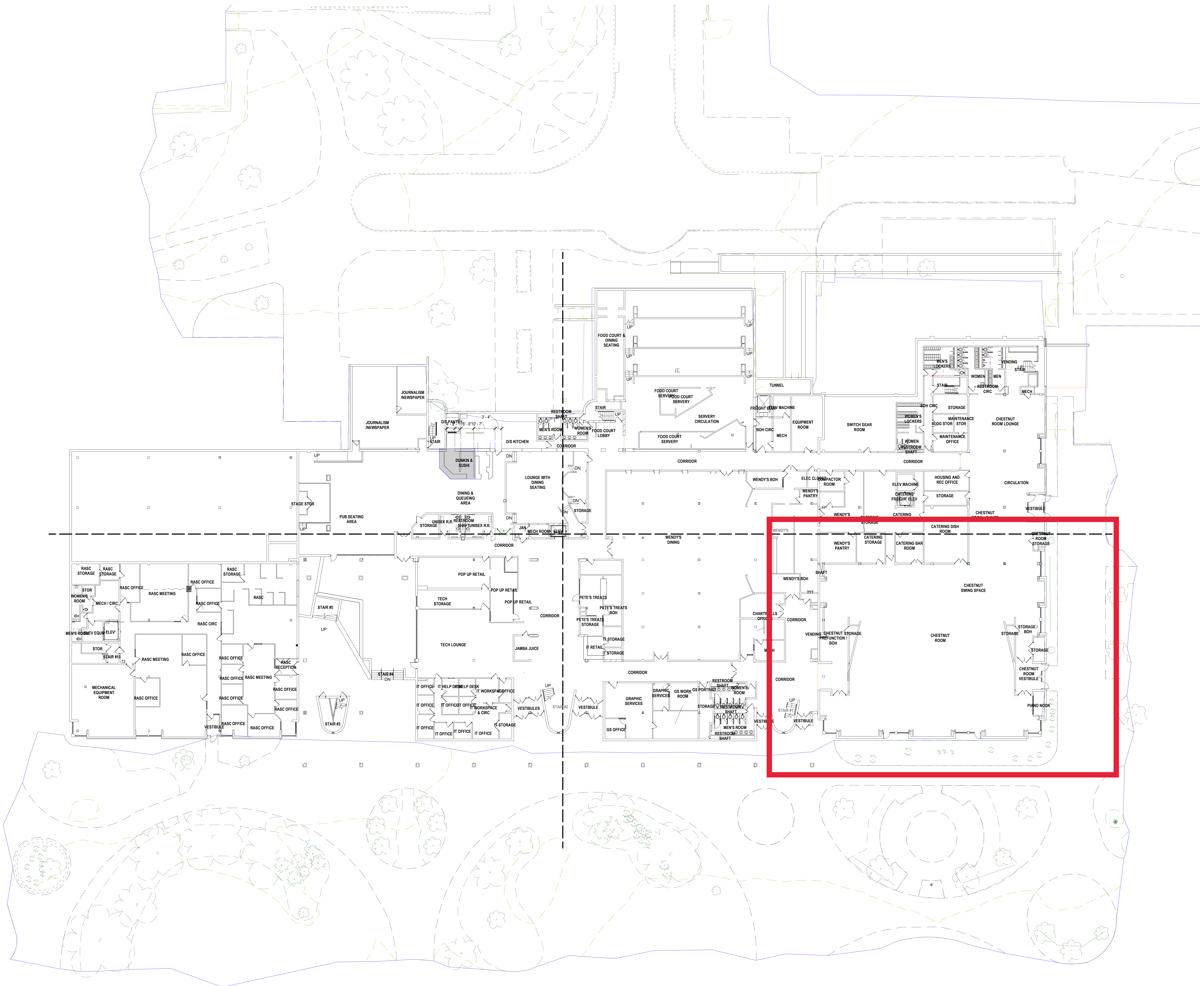

1st Floor Existing Plan

1/16" = 1'-0"

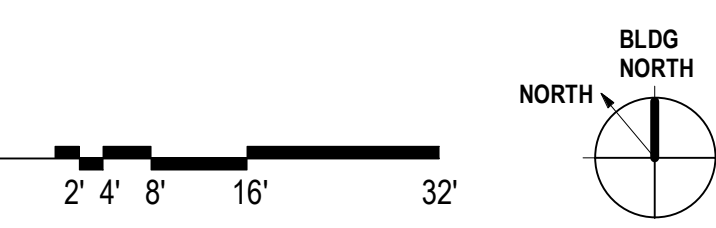

Exhibit G – YSU Meschel Hall Bridge

